

## 12V-250AH Solar Series VRLA Battery

### Solar Series

SunSurfs Solar Series Valve-regulated Lead Acid batteries use particular alloy and material technology design to ensure a excellent performance in various environments, especially high and low temp. SunSurfs Solar series batteries are optimal for storage and conversion of photovoltaic energy and wind energy.

### Application

Photovoltaic system  
Alternative Energy System  
Electric Utility  
Outdoor control Equipment  
Railroad Utility

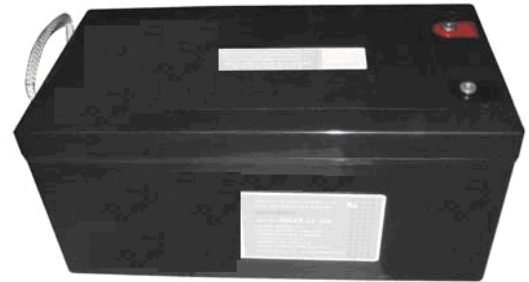

### General Features

Sealed and maintenance free operation.  
Non-Spillable construction design.  
ABS containers and covers(UL94HB, UL94V-0) optional.  
Safety valve installation for explosion proof.  
High quality and high reliability.  
Exceptional deep discharge recovery performance.  
Low self discharge characteristic.  
Flexibility design for multiple install positions.

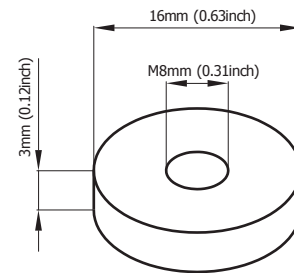

**Terminal Dimensions**

### Construction

Component	.....Raw material	Sealant	.....Epoxy Resin
Positive	.....Lead dioxide	Safety valve.	..... EPDR
Negative	.....Lead	Terminal	.....Copper
Container	.....ABS	Separator	.....AGM
Cover	.....ABS	Electrolyte	.....sulfuric acid

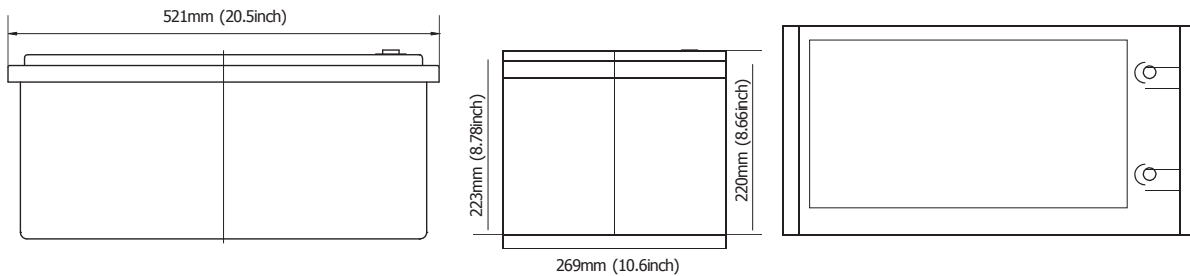

Battery Model	Solar 12-250			
Designed Floating Life	10 Years			
Capacity(20°C)	20HR(13.2A,1.80V)	10HR(25A,1.80V)	5HR(42.2A,1.75V)	1HR(157A,1.60V)
	264AH	250AH	211AH	157AH
Dimensions	Length	Width	Height	Total Height
	521mm(20.5inch)	269mm(10.6inch)	220mm(8.66inch)	223mm(8.78inch)
Approx. Weight	73.5Kg (162 lbs)			
Internal Resistance	Full charged at 20°C: 0.0026 Ohm			
Self Discharge	< 3% of capacity declined per month at (20°C)			
Capacity Affected by Temp.(20HR)	40°C	20°C	0°C	-15°C
	102%	100%	85%	65%
Charge Voltage(20°C)	Cycle use		Float use	
	14.4-14.8V(-30mV/ °C), max. Current: 62.5A		13.6-13.8V(-20mV/ °C)	

12V-250AH Solar Series VRLA Battery

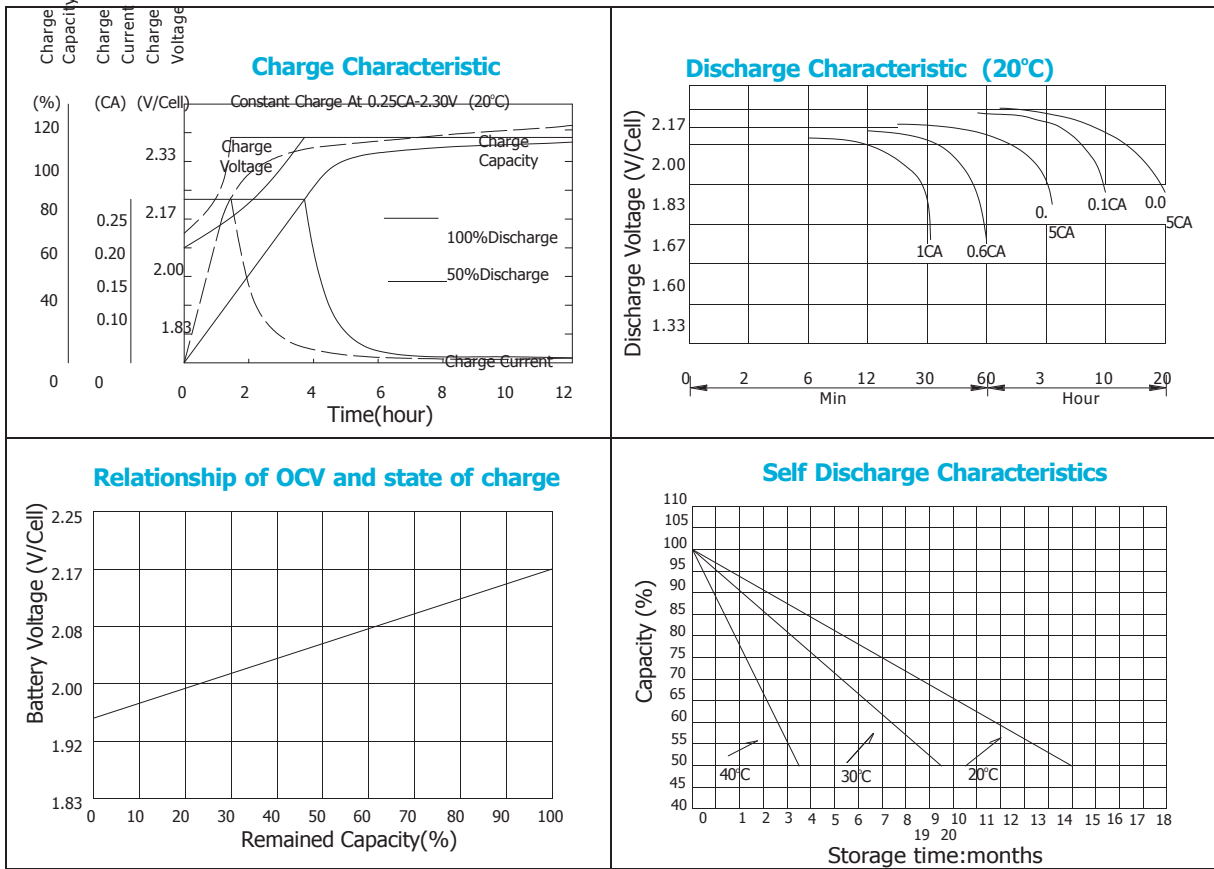

Constant current discharge ratings-amperes at 20°C

F.V/Time	5MIN	10MIN	15MIN	30MIN	1HR	3HR	5HR	10HR	20HR
1.60V	875	600	438	263	157	68.3	42.9	26.5	13.8
1.67V	788	548	425	255	157	68.0	42.6	26.1	13.8
1.70V	748	528	410	250	156	68.0	42.6	25.9	13.8
1.75V	665	488	388	245	154	67.5	42.2	25.5	13.7
1.80V	600	453	370	238	152	67.3	41.9	25.0	13.2
1.85V	455	373	320	219	151	67.0	41.5	24.6	12.4

Constant power discharge ratings-watts at 20°C

F.V/Time	5MIN	10MIN	15MIN	30MIN	1HR	3HR	5HR	10HR	20HR
1.60V	1443	995	775	495	325	131	91.3	53.0	26.4
1.67V	1368	983	768	485	314	131	91.3	52.2	26.3
1.70V	1278	958	755	473	306	131	91.3	51.8	26.3
1.75V	1190	895	710	460	303	129	90.3	50.9	26.1
1.80V	1068	833	668	448	298	127	88.8	50.0	25.2
1.85V	855	690	583	410	295	127	87.5	49.2	23.7

